

CW05 Crossrider Duo

| Component Number | Component Name | Size |
|------------------|-------------------------|----------------|
| 1.1 | Main Frame | ø60 x 3 |
| 1.2 | Flange Connecting Tube | ø76 x 3 |
| 1.3 | Elbow Tube Support | ø60 x 3 |
| 1.4 | Supporting Tube | ø60 x 3 |
| 1.5 | Main Axle Frame Welding | ø88 x 555.5 |
| 1.6 | Bearing Sleeve | ø73 x 150 |
| 1.7 | Flange Plate | ø128 x t13 |
| 1.8 | Anchor Plate | 148 x 110 x t8 |
| 1.9 | Round Plate | ø80 x t8 |
| 2.1 | Handle | ø32 x 3 |
| 2.2 | Bearing Sleeve | ø60 x 80 |
| 2.3 | Connecting Plate | ø42 x 3 |
| 2.4 | Bearing Sleeve | ø50 x 60 |
| 2.5 | Block Plate | ø30 x t1.8 |
| 3 | Right Swing Arm Welding | |
| 4.1 | Small Axle Welding | ø54 x 157.5 |
| 4.2 | Steel Casting | |
| 5.1 | Bearing Sleeve | ø60 x 88 |
| 5.2 | Pedal Connecting Tube | 40 x 40 x t2.5 |
| 5.3 | Square Clip | 50 x 60 x t8 |
| 5.4 | Square Block | 40 x 40 x t2 |
| 5.5 | Single Pedal | t4 |
| 6 | Left Swing Arm Welding | |
| 7 | Small Cover Base | M12 |
| 8 | Small Cover | M12 |
| 9 | Axle Pad | ø60 |
| 10 | Bearing | 6205 |
| 11 | Seal Ring | ø52 x 33 x t4 |
| 12 | Outside Hexagonal Bolt | M12 x 25 |
| 13 | Seal Ring | ø62 x 38 x t4 |

| Component Number | Component Name | Size |
|------------------|------------------------|----------------|
| 14 | Bearing | 6206 |
| 15 | Key | 8 x 10 x 30 |
| 16 | Cushion Washer | ø38 x ø30 x 6 |
| 17 | Big Axle | ø35 x 229 |
| 18 | Cap | ø60 |
| 19 | Retaining Nut | M12 |
| 20 | Retaining Washer | M12 |
| 21 | Damping | ø48 x 29 |
| 22 | Cushion Washer | ø32 x 2.5 x 5 |
| 23 | Scraper Seal | 6004 |
| 24 | Bearing | 6004 |
| 25 | Axle | ø20 x 110 |
| 26 | Grip | ø32 |
| 27 | Yellow Pad | ø37 x t3 |
| 28 | Seal Ring | ø52 x 28 t4 |
| 29 | Flat Bolts | M6 x 25 |
| 30 | Aluminium Alloy Plate | |
| 31 | Plastic Wood Plate | |
| 32 | Tube Sleeve | ø76 |
| 33 | Outside Hexagonal Bolt | M12 x 170 |
| 34.1 | Square Tube | 100 x 100 |
| 34.2 | Square Tube | 140 x 132 |
| 34.3 | Post Block Plate | 135 x 135 x t4 |



www.caloo.co.uk

Caloo Limited, Unit 12,
Boxted Farm, Berkhamsted
Road, Hemel Hempstead, HP1 2SG
Tel: +44 (0)8450558218
Fax: +44 (0)8450558219
Email: info@caloo.co.uk

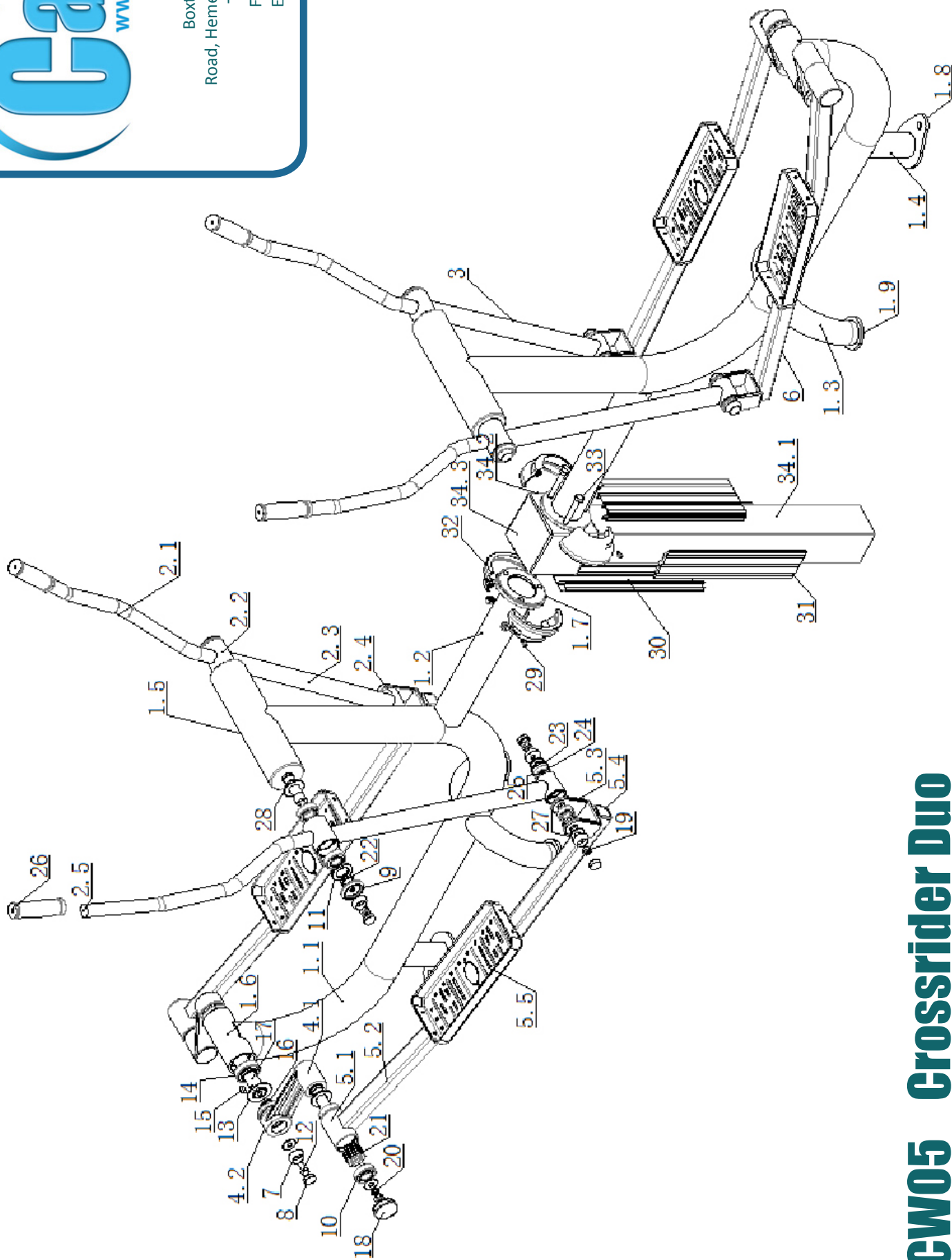

CW05 Crossrider Duo