



info@caloo.co.uk
01296 614448

CW23 Cross Rider

Component Number	Component Name	Size
1	Main Frame	Φ88X3
1.1	Post	Φ140X3
1.2	Axle Tube	Φ88X3
1.3	Axle	Φ28
1.4	Axle Pad	Φ80Xt6
1.5	Bearing Sleeve	Φ73X7
1.6	Triangular Rib plate	50X60Xt8
1.7	Flange	Φ260Xt12
1.8	Close Plate	
2	Handle	Φ32X2.75
2.1	Bearing Sleeve	Φ60X7
2.2	Connecting Tube	Φ42X2.75
2.3	Bearing Sleeve	Φ50X7
2.4	Connecting Plate	Φ25X3
4	Axle Base	Φ60
4.1	Crank Panel	205X70Xt14
4.2	Crank Panel Axle	Φ60
5	Bearing Sleeve	Φ60X7
5.1	Pedal connecting Pipe	40X40X2.5
5.2	Pedal	t4
5.3	Clip	60X50Xt8
5.4	Block	35X35Xt2
3	Right Arm Welding	
6	Right Pedal Welding	
7	Base	M12
8	Cap	M12
9	Axle Pad	Φ60
10	Bearing	6205
11	Waterproof Washer	6205
12	Sleeve Jump Spring	Φ52

Component Number	Component Name	Size
13	Yellow Pad	Φ37Xt2
14	Lock Nut	M12
15	Side Cover	Φ60
16	Key	8X10X40
17	Axle	Φ35
18	top thread	M8X15
19	Damp	Φ62X15
20	Bearing	6206
21	Waterproof Washer	6004
22	Bearing	6004
23	Handle Grip	Φ32
24	Handle Grip Cover	
25	Rivet	Φ4X13
26	Bearing	1205
27	Fundation Cover	Φ140
28	Inside hexagonal bolt	M8X20
29	Instruction	

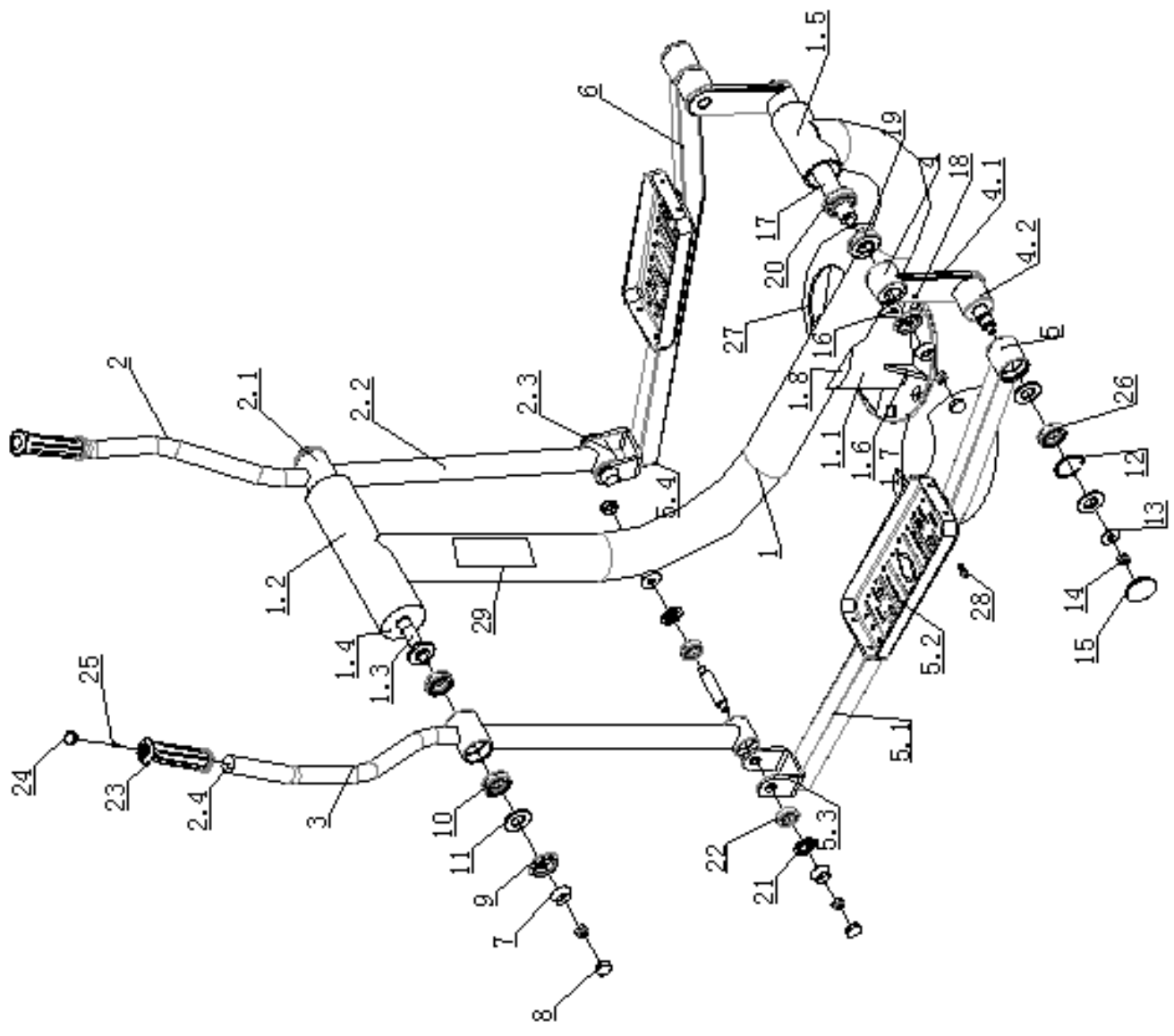

CW23 Cross Rider