

CW57 Lat Pull & Chest Press Combi

Component Number	Component Name	Size
1.1	Post	ø140 x 3
1.2	Pull Chair Shaft Bushing	ø76 x 3
1.3	Pull Chair Shaft Bushing	ø76 x 3
1.4	Shaft Bushing	ø73
1.5	Triangular Rib Plate	40 x 100 x t2
1.6	Pull Chair Connecting Pipe	ø76 x 3
1.7	Push Chair Connecting Pipe	ø76 x 3
1.8	Support Tube	ø60 x 3
1.9	Inner limit Stator	136 x 181 x t10
1.10	Limit Stator Connecting Plate	ø136 x t10
1.11	Round Plate	ø110 x t6
1.12	Round Plate	ø130 x t6
1.13	Steel Plate	16 x 136 x t6
1.14	Welding Plug	ø76
1.15	Flange	ø260 x t12
1.16	Triangular Rib Plate	50 x 60 x t8
2.1	Pull Arm Bend	ø42 x 3
2.2	Handle	ø27 x 2.5
2.3	Ear Plate	250.5 x 77 x t8
2.4	Welding Plate	ø42
3.1	Long Pull Arm Bend	ø42 x 3
3.2	Short Pull Arm Bend	ø42 x 3
4.1	Shaft Bushing	ø60 x 80
4.2	Pull Chair Seat Bend	ø60 x 3
4.3	U-clip	50 x 250 x t8
4.4	Square Seat	t4
4.5	Welding Plug	ø60
5.1	Push Chair Seat Bend	ø60 x 3
6.1	Limit Sleeve	ø135 x 5.5
6.2	Limit Triangular Rib Plate	

Component Number	Component Name	Size
6.3	Limit Connecting Pipe	ø50 x 6
6.4	Shaft Bushing	ø50 x 6
7.1	Push Chair Connecting Pipe	ø50 x 6
8	Axle	ø30 x 130
9	Axle	ø25 x 130
10	Axle	ø20 x 106
11	Cover	ø140
12	Rivet	ø5
13	Bearing	6206
14	Scraper Seal	6206
15	Retaining Nut	M12
16	Small Cover Base	M12
17	Small Cover	M12
18	Bearing	6205
19	Scraper Seal	6205
20	Bearing	6004
21	Scraper Deal	6004
22	Cap Cover	ø33
23	Cap	ø125
24	Axle	ø25 x 131
25	Axle	ø25 x 119
26	Axle Snap Ring	ø25
27	Limit Block	
28	Foundation Cover	ø140
29	Inside Hexagonal Bolt	M10 x 30
30	Grip	ø32
31	Yellow Pad	ø37 x t2

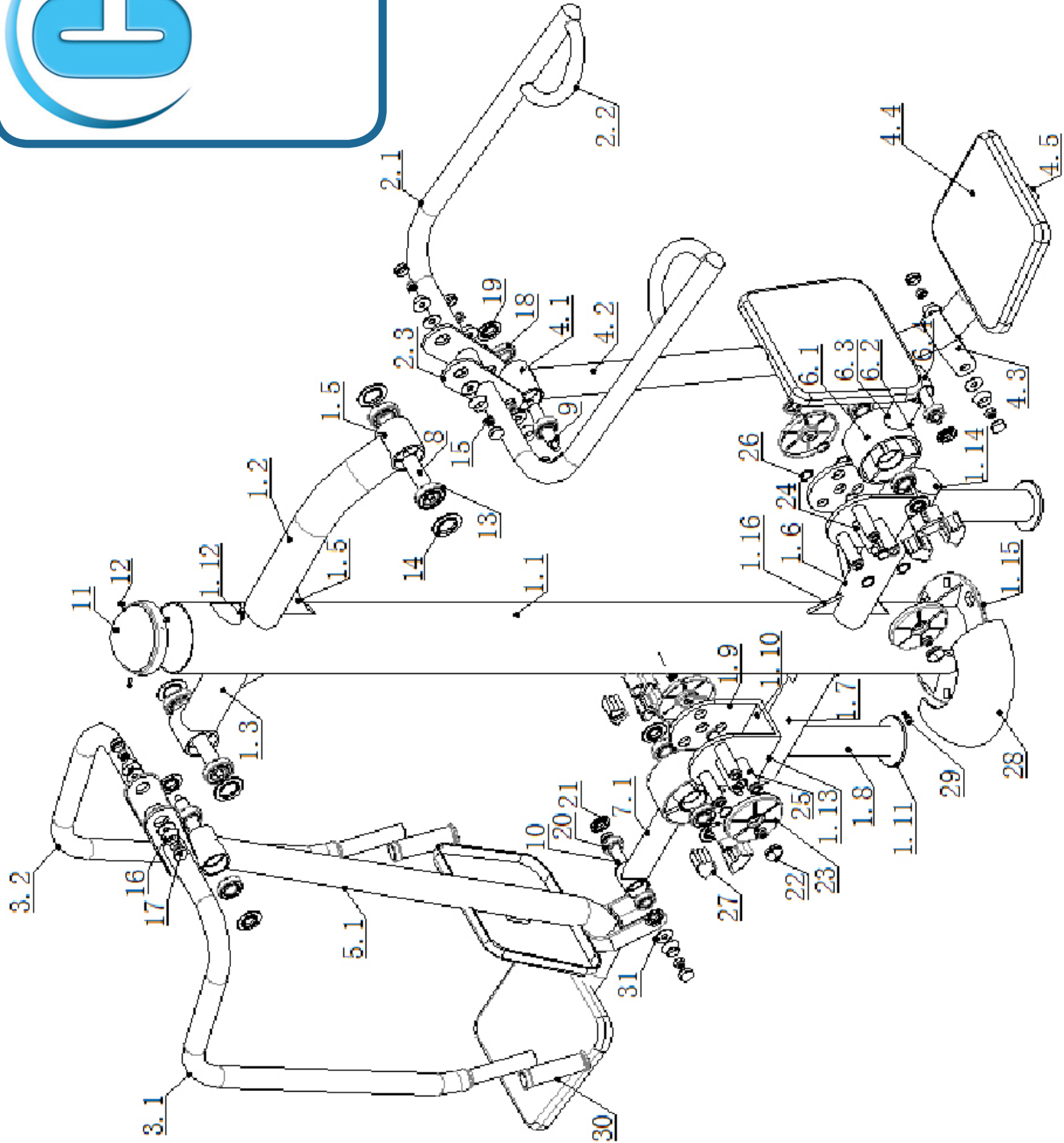

GW57 Lat Pull & Chest Press Combi