

CW01 Lat Pull

| Component Number | Component Name | Size |
|------------------|------------------------|-------------|
| 1 | Short Arm | Φ42X2.75 |
| 1.1 | Long Arm | Φ42X2.75 |
| 1.2 | Handle | Φ27X2.5 |
| 1.3 | Ear Plate | 250.5X77Xt8 |
| 1.4 | Welding Plate | Φ42 |
| 2 | Post | Φ140X3 |
| 2.1 | Axle Sleeve Tube | Φ76X2.75 |
| 2.2 | Axle Sleeve | Φ73 |
| 2.3 | Rib Plate | 40X80X2 |
| 2.4 | Connecting Tube | Φ76X2.75 |
| 2.5 | Supporting Tube | Φ60X2.75 |
| 2.6 | Limit Stator | 136X181Xt10 |
| 2.7 | Limit connecting Plate | Φ136Xt10 |
| 2.8 | Round Plate | Φ110Xt6 |
| 2.9 | Welding Plate | Φ76 |
| 2.10 | Flange | Φ260Xt12 |
| 2.11 | Rib Plate | 50X60Xt8 |
| 3 | Axle Sleeve | Φ60 |
| 3.1 | Seat Bend | Φ60X2.75 |
| 3.2 | Ear Plate Welding | 162.5X58 |
| 3.3 | Seat | 325X300 |
| 3.4 | Welding Plate | Φ60 |
| 4 | stop collar | Φ135X5.5 |
| 4.1 | connecting pipe | Φ50X6 |
| 4.2 | Axle Sleeve | Φ50X6 |
| 5 | Axle | Φ30 |
| 6 | Axle | Φ25 |
| 7 | Axle | Φ20 |
| 8 | Axle | Φ25 |
| 9 | Cover | Φ140 |

| Component Number | Component Name | Size |
|------------------|-----------------------|--------|
| 10 | Rivet | Φ5 |
| 11 | Bearing | 6206 |
| 12 | Waterproof Washer | 6206 |
| 13 | Lock Nut | M12 |
| 14 | Base | M12 |
| 15 | Cap | M12 |
| 16 | Bearing | 6205 |
| 17 | Waterproof Washer | 6205 |
| 18 | Bearing | 6004 |
| 19 | Waterproof Washer | 6004 |
| 20 | Anti-thief Bolt | M12X20 |
| 21 | Flat Washer | Φ12X30 |
| 22 | Plastic Stopper | |
| 23 | Fundation Cover | Φ140 |
| 24 | inside hexagonal bolt | M8X20 |
| 25 | Instruction | |
| 26 | Rivet | Φ4X13 |



www.caloo.co.uk

Caloo Limited, Unit 12, Boxted Farm, Berkhamsted
Road, Hemel Hempstead, HP1 2SG

Tel: +44 (0)84505558218

Fax: +44 (0)84505558219

Email: info@caloo.co.uk

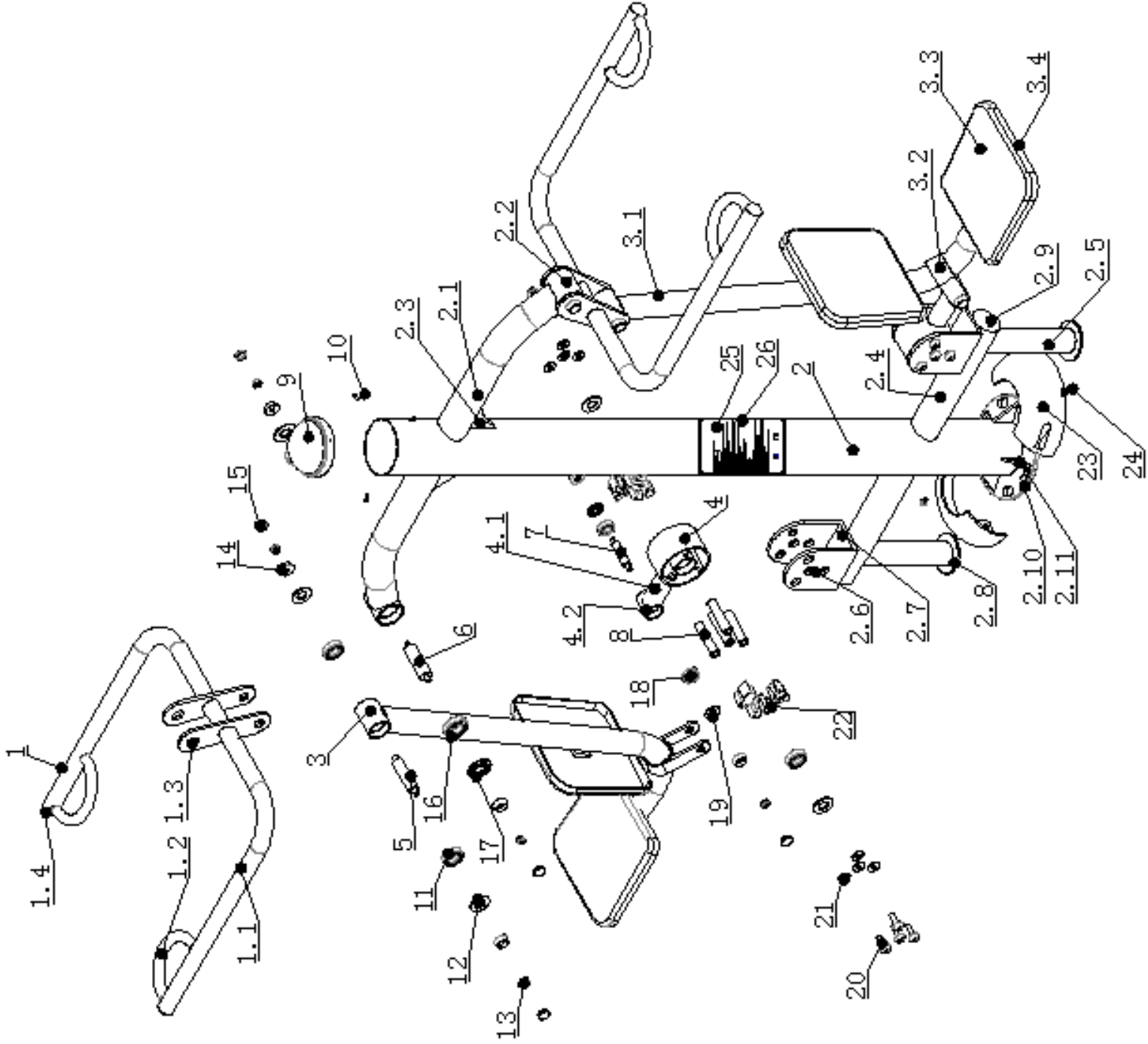

CW01 Lat Pull