

CW14 Rider

Component Number	Component Name	Size
1.1	Limit Stator	136X181Xt10
1.2	Post Supporting Tube	Φ102X4
1.3	Post Rib Plate	100X100Xt8
1.4	Post	Φ114X3
1.5	Post ear plate	Φ120X60Xt8
1.6	Base Frame	30X60Xt2
1.7	Embedded Tube	Φ48X2.5
1.8	Bed Plate	160X80Xt6
1.9	Plugging	25X55Xt2
1.10	Triangular Rib Plate	50X50Xt8
1.11	Flange	Φ260Xt12
1.12	Limit Connecting plate	135X85Xt10
2.1	Handle	Φ32X2.5
2.2	Upper Connecting Pipe	Φ48X3
2.3	Limit Rotor	Φ135X80
2.4	Pedal tube	Φ48X3
2.5	Antiskid Plate	
2.6	Connecting plate	Φ25Xt3
2.7	Down Connecting Pipe	Φ48X3
2.8	Rail Ear Plate	151X60Xt8
2.9	Intensive Rib Plate	
2.10	Welding plugging	Φ48
3.1	Connecting Pipe	Φ48X3
3.2	Bearing Sleeve	Φ60X55
4.1	Bearing Sleeve	Φ60X55
4.2	Seat Connecting Pipe	Φ48
4.3	Rail Ear Plate	151X60Xt8
4.4	Seat Rib Plate	
4.5	Seat	300X340Xt4
4.6	Welding plugging	Φ48

Component Number	Component Name	Size
5	Instruction	185X80Xt0.45
6	Rivet	Φ4X13
7	Cover	Φ114
8	Axle	Φ25X105
9	Base	M12
10	Cap	M12
11	Lock Nut	M12
12	Axle	Φ25X100
13	Flat Washer	M12X3
14	Anti-thief Bolt	M12X20
15	Waterproof Washer	6205
16	Plastic Stopper	
17	Bearing	6205
18	Handle Grip	Φ32
19	Handle Grip Cap	
20	Yellow Pad	Φ37Xt2
21	Inside hexagonal bolt	M8X25
22	Foundation Cover	Φ114



www.caloo.co.uk

Caloo Limited, Unit 12, Boxted Farm, Berkhamsted
Road, Hemel Hempstead, HP1 2SG
Tel: +44 (0)84505558218
Fax: +44 (0)84505558219
Email: info@caloo.co.uk

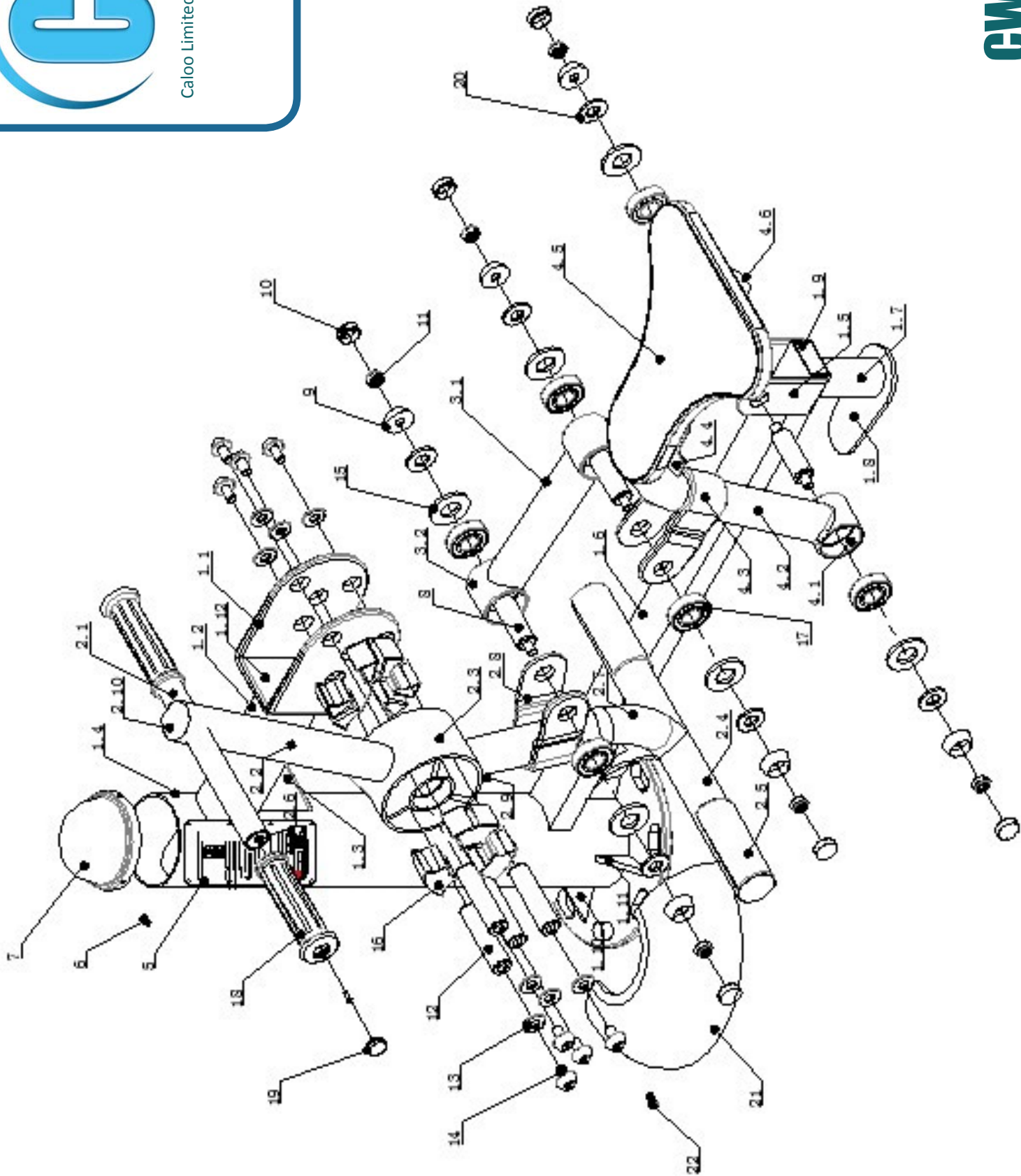

CW14 Rider