

# WD 1417

## GYMNASTIC CUBE

| DEVICE SPECIFICATIONS              |                      |
|------------------------------------|----------------------|
| Safety zone                        | 22,28 m <sup>2</sup> |
| Length                             | 1,60 m               |
| Width                              | 0,85 m               |
| Total height                       | 2,30 m               |
| Free fall height                   | 2,20 m               |
| Age range                          | 3-14 years           |
| In accordance w/ EN standards      | 1176-1:2009          |
| Availability of spare parts        | Yes                  |
| Weight of the heaviest part [kg]   | 13                   |
| Dimension of the biggest part [cm] | 300x9x9              |

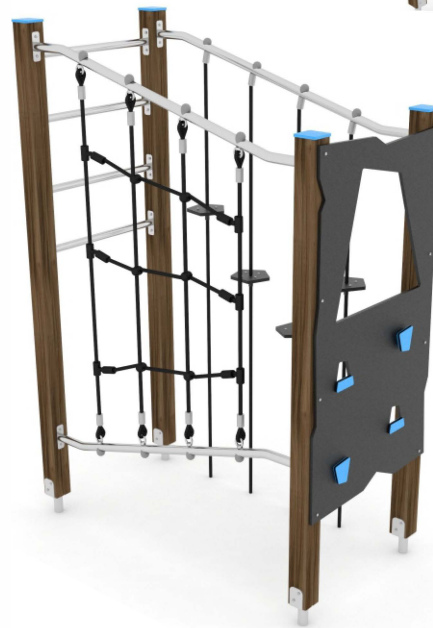

### Minimal space

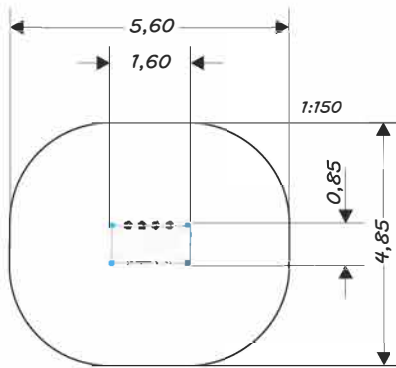

### MATERIAL SPECIFICATION

- 90 x 90 mm impregnated, laminated wood of pine, the top is protected with polypropylene caps
- Foundations are made of metal, sheltering the wood from direct contact with the ground to prevent rot and extend the products life
- Antyslip and waterproof plywood platform and climbing walls
- Shields and roofs made out of atmospheric condition resistant HDPE polythene plates
- Stainless steel screws or covered screws with plastic caps
- No sharp edges or chinks that would pose a danger for jamming of the head, fingers or any other body parts
- Steel ropes enclosed with polypropylene, linked by durable plastic elements
- Handrails and bars made out stainless steel

### ADDITIONAL COMMENTS

- The device is designed for public playgrounds

Due to the free fall height of the device, the EN 1176-1:2009 standard allows the following surfaces to cushion a fall. The level of granular materials requires filling in, conservation of synthetic materials is required in accordance with the manufacturer's instructions. Dimensions of the foundation are described in installation instruction.

| Material            | Description [mm]               | Minimal layer thickness [mm] | Dimensions foundation |
|---------------------|--------------------------------|------------------------------|-----------------------|
| Tree bark           | Grain size from 20 to 80       | 400                          | A,C                   |
| Chip                | Grain size from 5 to 30        | 400                          | A,C                   |
| Sand                | Grain size from 0,2 to 2       | 400                          | A,C                   |
| Gravel              | Grain size from 2 to 8         | 400                          | A,C                   |
| Synthetic materials | Free fall approval $\geq 2200$ |                              | A,B,C                 |